

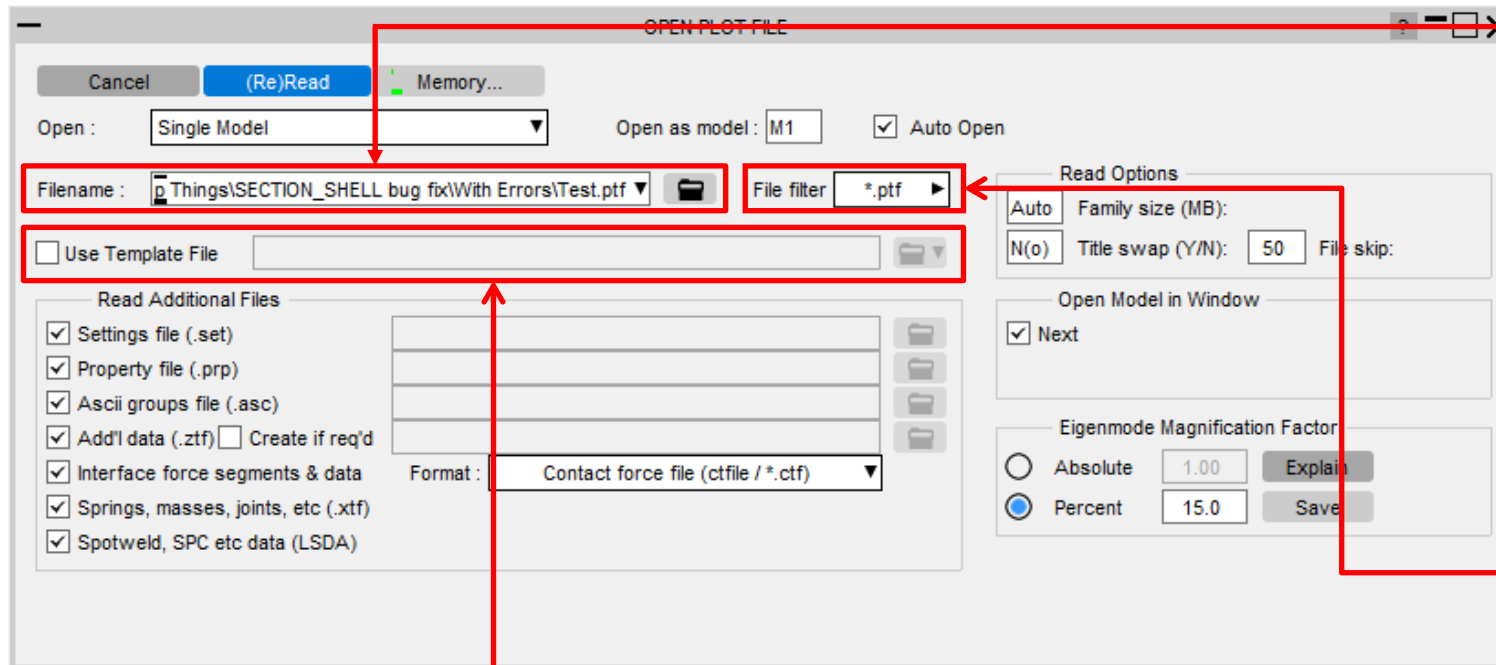

Opening Models – Single Model



File Options

- The default **Open Model** menu allows for single or multiple models to be selected by either typing in a filename or browsing for a file.
- This particular example will go through opening a single model.



Filename for the model file to be opened can be typed into the text entry box or the folder button  can be used to search for the required model file. Recent files can be found in the drop down menu.

The file filter option is used to select which file extension to search for when selecting a model file to open. For LSTC filenames (D3PLOT, etc), select d3*, within the file filter popup menu.

The Use Template File panel allows template files to be read in, which can contain information such as; which windows models are located in, model offsets, colours and initial plotting modes.

File Options

Settings File	Contains window settings: background colour, data component, etc
Properties File	Contains model properties: colours, blanking, transparency, etc
Ascii groups	Group information
Add'l data (.ztf)	Contains additional data used by D3PLOT to plot items not in the ptf/d3plot file (created by PRIMER), e.g. beam sections, composite layouts,
Create if req'd	This will automatically open PRIMER, read in the keyword matching the ptf filename, generate a ztf file, save it in the same folder and close PRIMER.
Contact data (.ctf)	Contains information on contact surface locations and forces
Spring / mass (.xtf)	Contains information on springs, lumped masses, joints
Spot weld, SPC (LSDA)	Contains data for spot welds, SPCs, seatbelts, X-sections

The Read Additional Files panel allows additional files to be read. With the Auto Open option selected, D3PLOT automatically selects these additional files to be read. Deselecting the Auto Open option, allows the file names of the additional files to be modified and allows the user to manually search for a particular additional file.

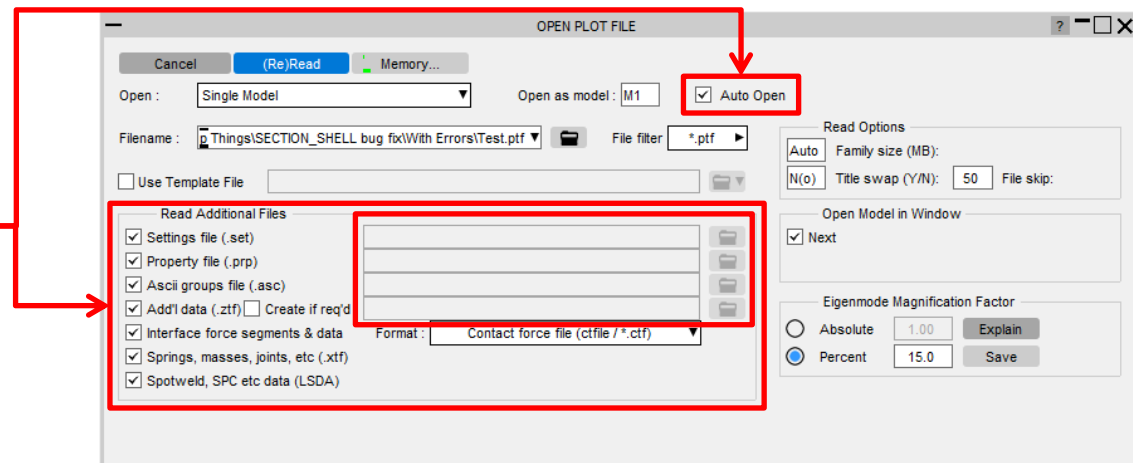

File Association

To set D3PLOT as the default program to open a .ptf in Windows: right click on a .ptf file in **Windows Explorer > Open with > Choose another app > More apps > select D3PLOT**. The file should then automatically open within D3PLOT.

If you open a .ptf file using this method, you will not get the options on the open plot file menu in the previous slide.

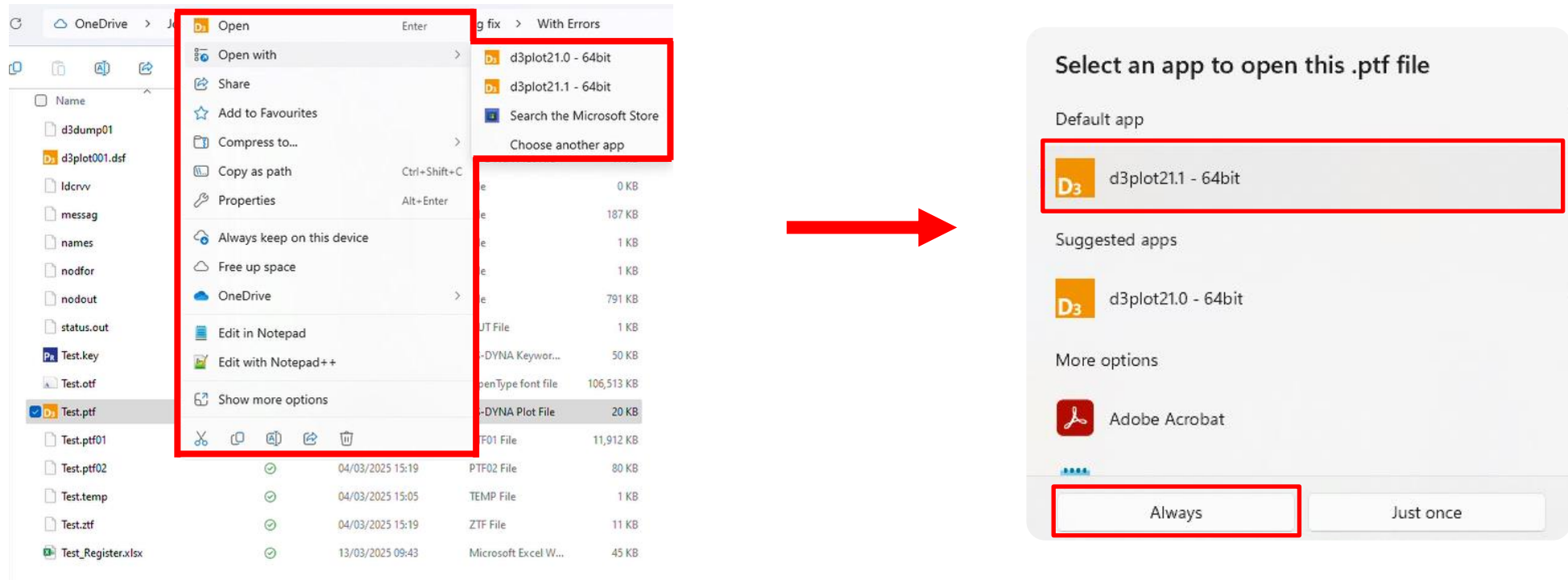

Drag & Drop

With D3PLOT open, you can also drag and drop in a .ptf file and it will read in.

d3dump01	✓	04/03/2025 15:19	File	1,423 KB
d3plot001.dsf	✓	04/03/2025 16:51	LS-DYNA Plot File	17 KB
ldcrvv	✓	04/03/2025 13:36	File	0 KB
messag	✓	04/03/2025 15:19	File	187 KB
names	✓	04/03/2025 15:05	File	1 KB
nodfor	✓	04/03/2025 15:05	File	1 KB
nodout	✓	04/03/2025 15:19	File	791 KB
status.out	✓	04/03/2025 15:05	OUT File	1 KB
Test.key	✓	04/03/2025 15:04	LS-DYNA Keywor...	50 KB
Test.otf	✓	04/03/2025 15:19	OpenType font file	106,513 KB
Test.ptf	✓	04/03/2025 15:05	LS-DYNA Plot File	20 KB
Test.ptf01	✓	04/03/2025 15:19	PTF01 File	11,912 KB
Test.ptf02	✓	04/03/2025 15:19	PTF02 File	80 KB
Test.temp	✓	04/03/2025 15:05	TEMP File	1 KB
Test.ztf	✓	04/03/2025 15:19	ZTF File	11 KB
Test_Register.xlsx	✓	13/03/2025 09:43	Microsoft Excel W...	45 KB

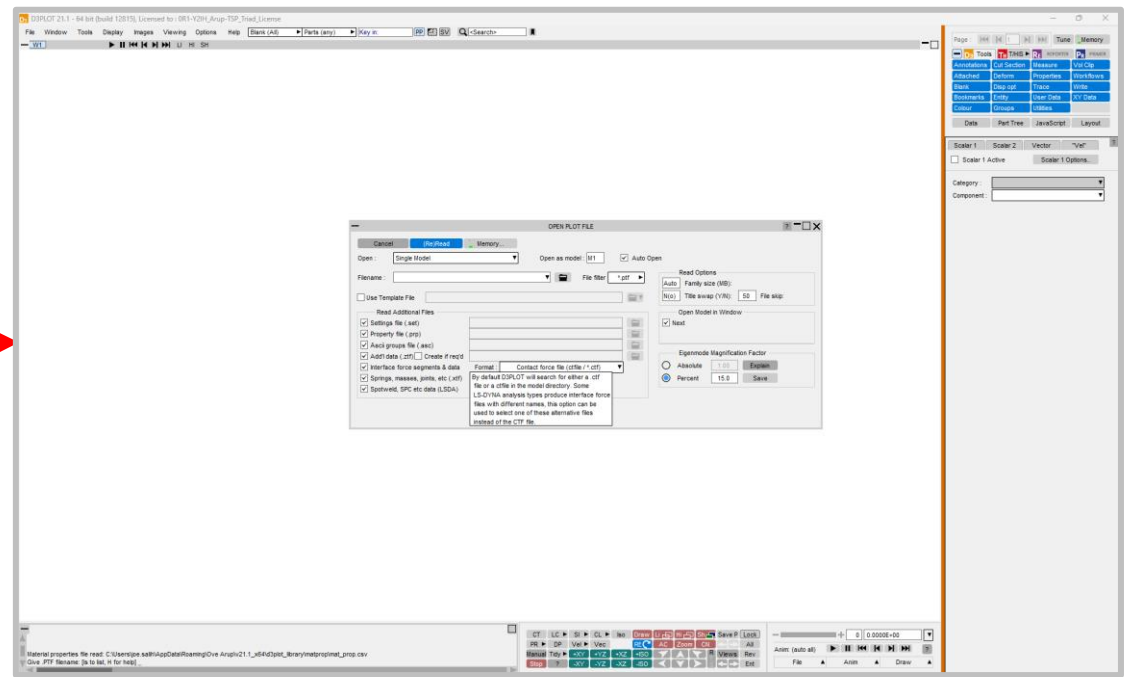

Contact us

Global / UK

T: +44 121 213 3399

E: dyna.support@arup.com

India

T: +91 40 69019723 / 98

E: india.support@arup.com

China

T: +86 21 3118 8875

E: china.support@arup.com

USA

T: +1 415 940 0959

E: us.support@arup.com

Subscribe to
our newsletter:



Follow us on:



@Oasys LS-DYNA
Environment



@Oasys LS-DYNA
Environment



@Oasys



@Oasys

<https://www.oasys-software.com/dyna/>